





# NORTHCOTE TOWN HALL ARTS CENTRE- MAIN HALL

1:115 Scale

**LENGTH:** 24m (curtain to end of hall)

**WIDTH:** 13.8m      **CAPACITY:** •300 seated theatre • Banquet function

**HEIGHT:** 9.5m      **NOTES:** 330m2 •wheel chair accessible •wooden floorboards •west wing kitchen •heaters •blinds

-  Light Switch
-  Power Point
-  3-Phase Outlet
-  Trestle Table (for reference)

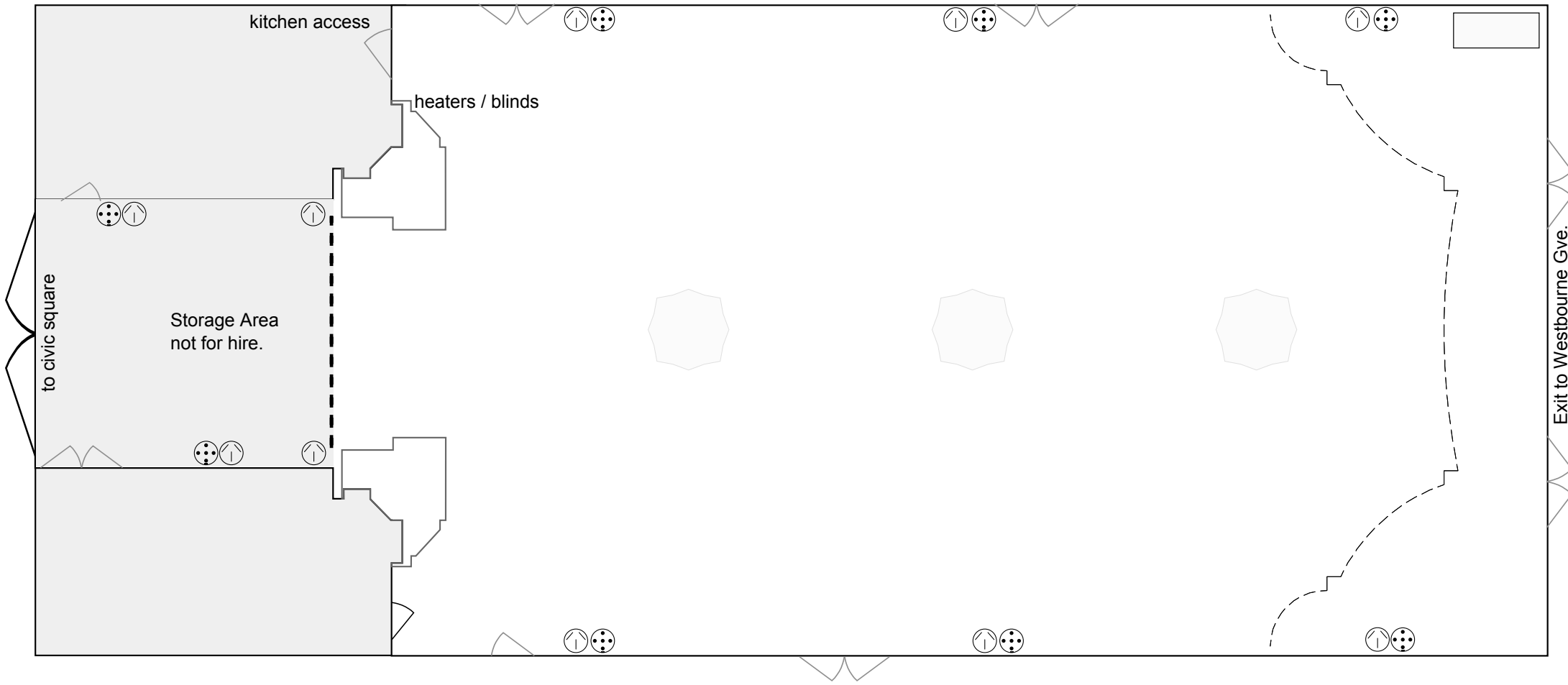

Main Entrance / Exit to Foyer

 Lights for the hall are controlled from Store room A (next to hall)